

SPECIFICATIONS

DESCRIPTION:

MR16 halogen traditional style sign light with a 36" post. Suitable for wet/damp/dry location installations.

MATERIAL:

Standard overall material is 6061 aluminum.
HL-736 - Machined Aluminum

FINISH:

- AA - Anodized Satin Aluminum
- AP - Powder Coat Aluminum
- BK - Powder Coat Black
- BZ - Powder Coat Bronze
- WT - Powder Coat White

LAMPING:

Lamp Type - 12V halogen MR16 lamp, bi-pin
 GX5.3 base, 50W max, not included.

VOLTAGE:

12 - 12 VAC output transformer required, not included.

MOUNTING:

Fixture is equipped with a 4.75" mounting plate and (2) mounting screws.

OPTIONS:

Glare shields

- GL-10 - Short Angled, aluminum
- GL-11 - Angled, aluminum
- GL-13 - Straight, aluminum

Lenses/Louvers/Color Filters

- LA-1 - Hexcell Louver (Black)
- LA-2 - Prismatic lens
- LA-3 - Linear spread lens
- LA-4 - Soft focus lens (diffused)
- LA-5 - Moonlight lens
- LA-6 - Blue lens

See fixture accessories for more information.

SAMPLE ORDER SPECIFICATION:

HL-736-AA-12-GL-11-LA-1

RATING:

Wet/damp/dry location.



MADE IN THE USA

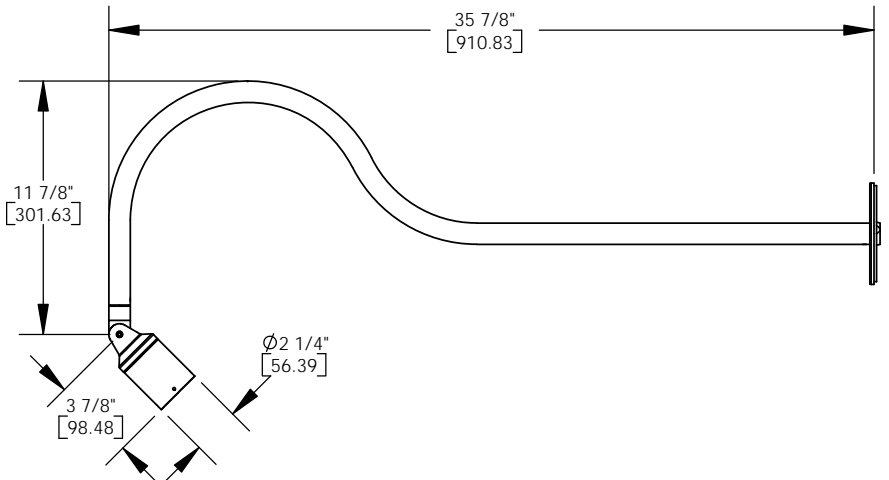
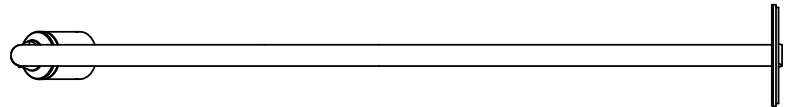
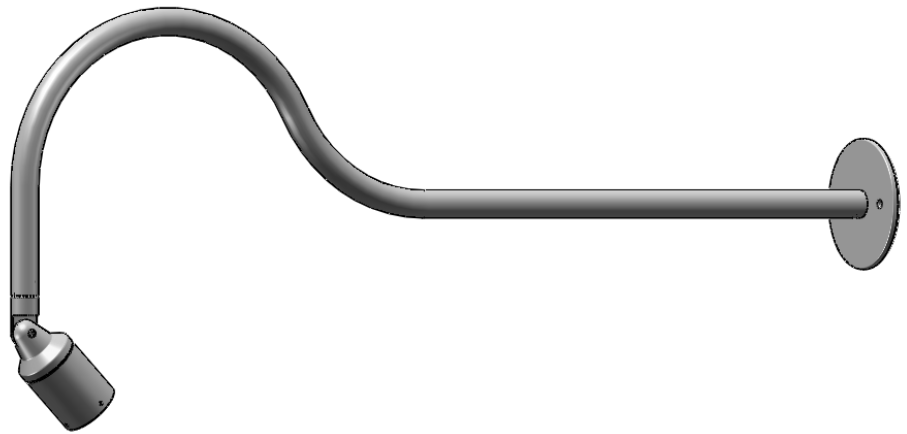
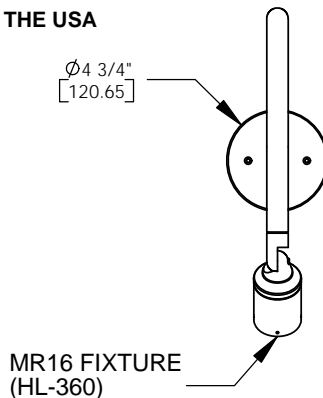

ORDER SPECIFICATION: _____ - _____ - _____ - _____ - _____
Fixture Finish Lamping Voltage Options/Access.

PROJECT: _____
APPROVED: _____
NOTE: _____
TYPE: _____

HEVI LITE, INC.
 7524 Deering Ave, Canoga Park, CA 91303
 Tel., (818) 710-0728 - Fax (818) 710-0756
 Web Site <http://www.hevilite.com>

CATALOG NUMBER:

HL-736