

SPECIFICATIONS

DESCRIPTION:

Compact LED accent fixture with a machined mounting plate. Suitable for wet/damp/dry location installations.

MATERIAL:

Standard overall material is 6061 aluminum.
HL-320-LED - Machined Aluminum

FINISH:

AA - Anodized Satin Aluminum
AP - Powder Coat Aluminum
BK - Powder Coat Black
BZ - Powder Coat Bronze
WT - Powder Coat White

LED OPTIONS

Integral high output LED, warm white 85 CRI (90 available)
2700K or **3000K** Standard (**4000K**, **5000K**, & **6000K** available)
1LED - 1W (42 lumens)

OPTICS

SP - Spot, 12°
NF - Narrow Flood, 24°
FL - Flood, 36°

VOLTAGE:

Driver - 350mA output driver required, not included.

MOUNTING:

Fixture is equipped with 3.50" mounting plate and (2) mounting screws.

OPTIONS:

Glare shields

GL-1 - Angled, aluminum

GL-3 - Straight, aluminum

Lenses/Louvers/Color Filters

LA-1-8 - Hexcell Louver (Black)

LA-2-8 - Prismatic lens

LA-3-8 - Linear spread lens

LA-4-8 - Soft focus lens (diffused)

LA-5-8 - Moonlight lens

LA-6-8 - Blue lens

LED Constant Current Drivers

HLD-3-350-12 - 3W 350mA 12VAC driver

HLD-3-350-U - 3W 350mA 120-277VAC driver

See fixture accessories for more information.

SAMPLE ORDER SPECIFICATION:

HL-320-LED-BK-12-GL-1-LA-3-8

RATING:

Wet/damp/dry location.



Intertek

MADE IN THE USA

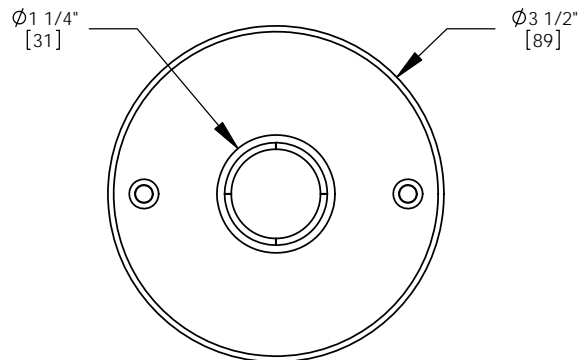
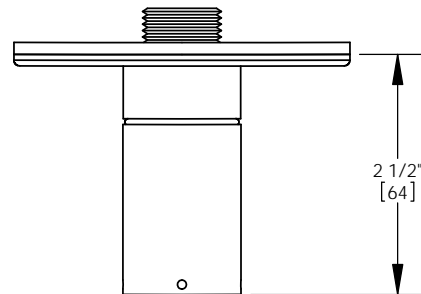
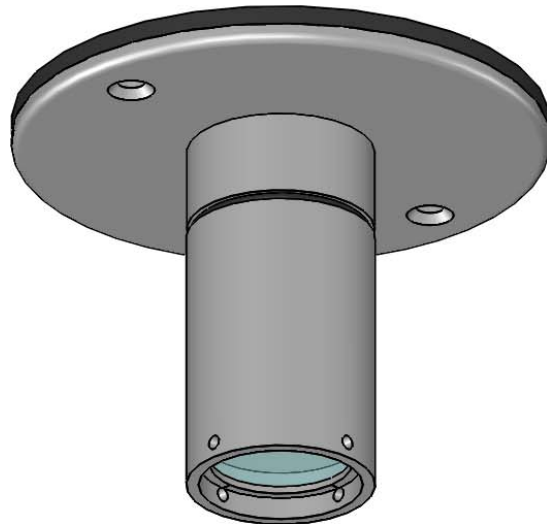

ORDER SPECIFICATION: _____ - _____ - _____ - _____ - _____
 Fixture Finish Lamping Voltage Options/Access.

PROJECT:

APPROVED:

NOTE:

TYPE:



HEVI LITE, INC.

9714 Variel Ave, Chatsworth, CA 91311
 Tel., (818) 341-8091 - Fax (818) 998-1986
 Web Site <http://www.hevilite.com>

CATALOG NUMBER:

HL-320-LED

Driver Options



HLD-3-350-12

Compact dimmable 12-Volt / 350mA constant current LED driver for 1-3W LEDs.
Driver is dimmable standard with MLV TRIAC dimmer.



HLD-3-350-U

Compact universal voltage (100-277v) 350mA constant current LED driver for 1-3W LEDs. Non-dimmable.

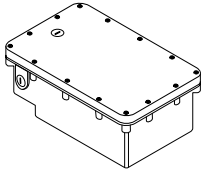

HLD-CBB

Direct burial composite enclosure with (1)LED driver and (1)fixture mount location.
Enclosure comes standard with junction compartment and anti-siphon chamber ensures no water can enter the main housing.

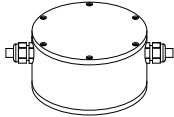

H-POD-LED

Direct burial LED Driver pod with (1) driver. Pod is equipped with moisture-lock cords to prevent water wicking.
Suitable for wet/damp/dry location installation.

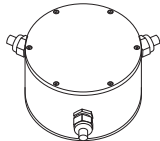

H-POD-LED-2X

Direct burial LED Driver pod with (2) LED drivers. Pod is equipped with moisture-lock cords to prevent water wicking.
Suitable for wet/damp/dry location installation.

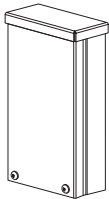

HL-RD

3R rated rain tight stainless steel enclosure with (1) LED driver. Suitable for wet/damp/dry location installations.

HL-RD-2X

3R rated rain tight stainless steel enclosure with (2) LED drivers. Suitable for wet/damp/dry location installations.

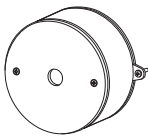

SMED

Surface mount canopy with (1) LED driver, for (1) fixture. Suitable for wet/damp/dry location installations.

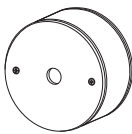

WMED

Wall mount canopy with (1) LED driver, for (1) fixture. Suitable for wet/damp/dry location installations.

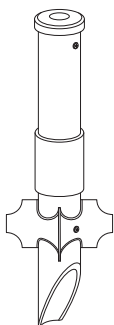

GM-9-LED

LED driver in PVC landscape post/mounting spike for ground mounting applications.
Suitable for wet/damp/dry location installations.