

# SPECIFICATIONS

**DESCRIPTION:**

Wall mount square Up/Down MR16 accent fixture. Suitable for wet/damp/dry location installations.

**MATERIAL:**

Standard overall material is 6061 aluminum.  
**HL-340S-2X** - Machined Aluminum

**FINISH:**

- AA** - Anodized Satin Aluminum
- AP** - Powder Coat Aluminum
- BK** - Powder Coat Black
- BZ** - Powder Coat Bronze
- WT** - Powder Coat White

**HALOGEN LAMPING OPTION:**

Lamp Type - 12V halogen MR16 lamp, bi-pin GX5.3 base, 50W max, not included (standard).

**LED OPTIONS:**

Integral high output LED, warm white 85 CRI (90 available)  
**2700K** or **3000K** Standard (**4000K**, **5000K**, & **6000K** available)

- 3LED** - 3W LED - 180 lumens
- 8LED** - 8W LED - 300 lumens
- 8LED-E** - 8.4W LED - 565 lumens

**OPTICS**

3LED and 8LED:

- SP** - Spot, 12°
- NF** - Narrow Flood, 24°
- FL** - Flood, 36°

8LED-E:

- SP** - Spot 14°
- NF** - Narrow Flood, 25°
- MF** - Medium Flood, 30°
- FL** - Flood, 40°

**VOLTAGE:**

**12** - 12 VAC output transformer required, not included.

**MOUNTING:**

Fixture is equipped with a 4.75" mounting plate and (2) mounting screws.

**OPTIONS:**

Lenses/Louvers/Color Filters

- LA-1** - Hexcell Louver (Black)
- LA-2** - Prismatic lens
- LA-3** - Linear spread lens
- LA-4** - Soft focus lens (diffused)
- LA-5** - Moonlight lens
- LA-6** - Blue lens

See fixture accessories for more information.

**RATING:**

Wet/damp/dry location.

**MADE IN THE USA**

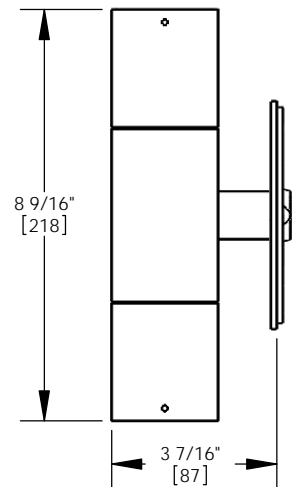
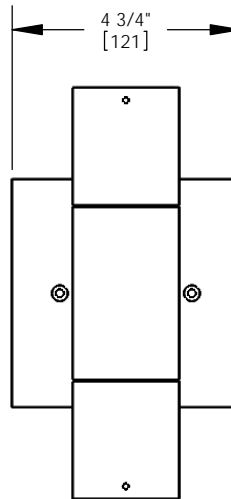
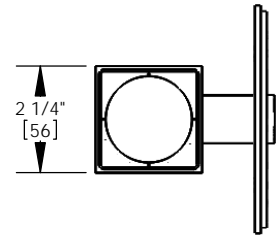
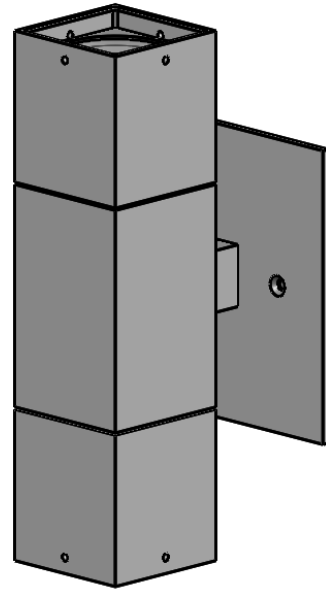

ORDER SPECIFICATION: \_\_\_\_\_ - \_\_\_\_\_ - \_\_\_\_\_ - \_\_\_\_\_ - \_\_\_\_\_  
Fixture Finish Lamping Voltage Options/Access.

PROJECT:

APPROVED:

NOTE:

TYPE:

**H** HEVI LITE, INC.  
 9714 Variel Ave, Chatsworth, CA 91311  
 Tel., (818) 341-8091 - Fax (818) 998-1986  
 Web Site <http://www.hevilite.com>

CATALOG NUMBER:

**HL-340S-2X**