

# SPECIFICATIONS

**DESCRIPTION:**

Compact wedge shaped step light. Suitable for wet/damp/dry location installations.

**MATERIAL:**

Standard overall material is 6061 aluminum.  
**HL-1181** - Machined Aluminum (Standard)  
**HL-1181-1** - Machined Stainless Steel  
**HL-1181-2** - Machined Brass

**FINISH:**

**AA** - Anodized Satin Aluminum  
**AP** - Powder Coat Aluminum  
**BK** - Powder Coat Black  
**BZ** - Powder Coat Bronze  
**WT** - Powder Coat White  
**N** - Natural, for Stainless Steel and Brass

**HALOGEN LAMPING OPTION:**

Lamp Type - 12V halogen T3 lamp, bi-pin G4 base, 35W max, included (20W Xenon lamp included when halogen is not specified).

**10** - 10W lamp  
**20** - 20W lamp  
**35** - 35W lamp

**LED OPTIONS:**

Integral high output LED, warm white (3000K CCT) standard, others available.

**1LED** - 1W LED  
**3LED** - 3W LED

**VOLTAGE:**

**12** - 12 VAC output transformer required, not included.

**MOUNTING:**

Mounts directly to standard single-gang electrical junction boxes.

**SAMPLE ORDER SPECIFICATION:**

HL-1181-AA-12

**RATING:**

Wet/damp/dry location.



**MADE IN THE USA**

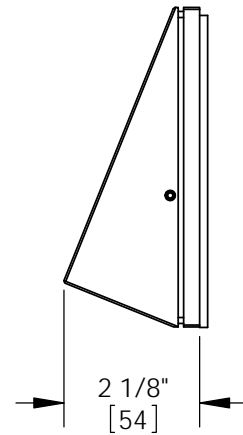
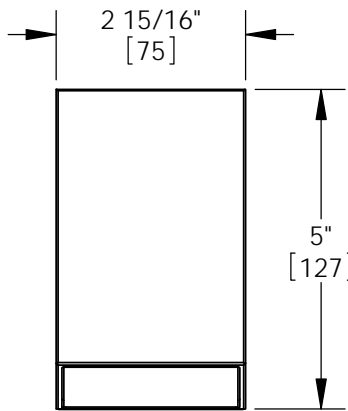
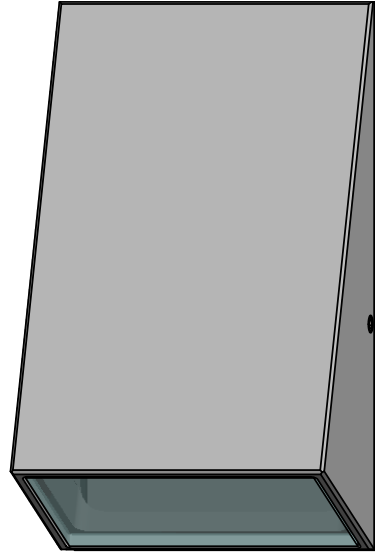

**ORDER SPECIFICATION:** \_\_\_\_\_ - \_\_\_\_\_ - \_\_\_\_\_ - \_\_\_\_\_ - \_\_\_\_\_  
Fixture Finish Lamping Voltage Options/Access.

**PROJECT:** \_\_\_\_\_  
**APPROVED:** \_\_\_\_\_  
**NOTE:** \_\_\_\_\_  
**TYPE:** \_\_\_\_\_

**HEVI LITE, INC.**  
 9714 Variel Ave, Chatsworth, CA 91311  
 Tel., (818) 341-8091 - Fax (818) 998-1986  
 Web Site <http://www.hevilite.com>

CATALOG NUMBER:  
**HL-1181**