

SPECIFICATIONS

DESCRIPTION:

Wall mount Up/Down PAR30 metal halide accent fixture. Suitable for wet/damp/dry location installations.

MATERIAL:

Standard overall material is 6061 aluminum.
HL-476-2X - Machined Aluminum

FINISH:

- AA** - Anodized Satin Aluminum
- AP** - Powder Coat Aluminum
- BK** - Powder Coat Black
- BZ** - Powder Coat Bronze
- WT** - Powder Coat White

LAMPING:

Lamp Type - HID metal halide PAR30 lamps, medium base, not included.
35 - 39W lamp/ballast
70 - 70W lamp/ballast

VOLTAGE:

Ballast - Remote ballast standard (HL-RB, 3R rated stainless steel enclosure, 7.3"x4.2"x2.1"). HID electronic metal halide ballast included. See Options.
120-277 - 120-277V multi-volt ballast

OPTIONS:

Ballast options available in place of HL-RB for direct burial, surface and wall mounting.
H-POD - Direct burial ballast.

MOUNTING:

Fixture is equipped with a 4.75" mounting plate and (2) mounting screws.

OPTIONS:

Glare shields
GL-30 - Angled, aluminum
GL-31 - Straight, aluminum
 See fixture accessories for more information.

SAMPLE ORDER SPECIFICATION:

HL-476-2X-AA-35-120-277-GL-31



MADE IN THE USA

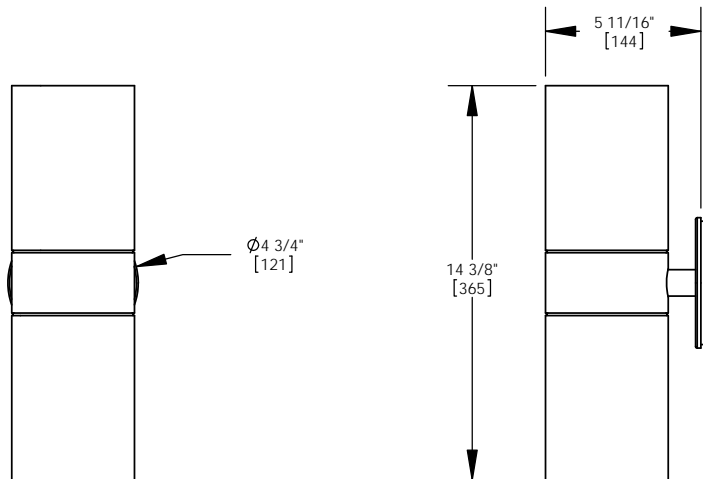
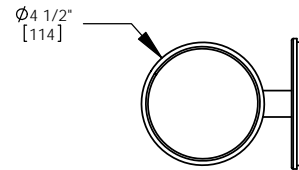
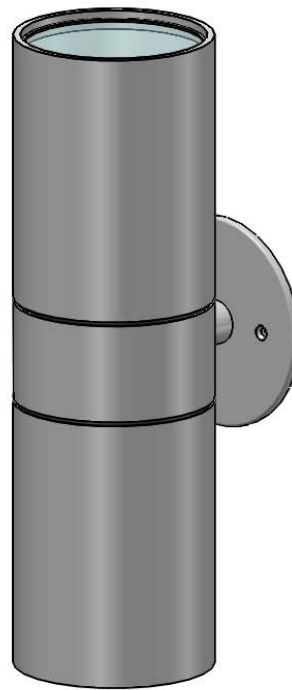

ORDER SPECIFICATION: _____ - _____ - _____ - _____ - _____
Fixture Finish Lamping Voltage Options/Access.

PROJECT: _____
APPROVED: _____
NOTE: _____
TYPE: _____

HEVI LITE, INC.
 9714 Variel Ave, Chatsworth, CA 91311
 Tel., (818) 341-8091 - Fax (818) 998-1986
 Web Site <http://www.hevilite.com>

CATALOG NUMBER:
HL-476-2X