

MATERIAL:

Standard overall material is 6061 aluminum.

HL-822 - Machined Aluminum

HALC ; EB LAMDIB ; CDTICB:

Lamd Tmde - 12J halo [en MR16 lamdž Vi-din ; L). ' Vasež)OK ma lž not included fstandardž.

LE8 CDTICBS

Inte[ral hi[h outdut LE8ž karm khilž 7RI fi'000? 77Tl standardž others availaVle.

'LE8 - ' K LE8 - 180 lumens

8LE8 - 8K LE8 - '00 lumens

8LE8-E - 8.(K LE8 -)6) lumens

CDTI7S

'LE8 and 8LE8:

SD - Sdotž 12š

B: - Barrok :loodž 2(š

:L - :loodž '6š

8LE8-E.

SD - Sdot 1(š

B: - Barrok :loodž 2)š

M: - Medium :loodž '0š

:L - :loodž (0š

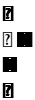
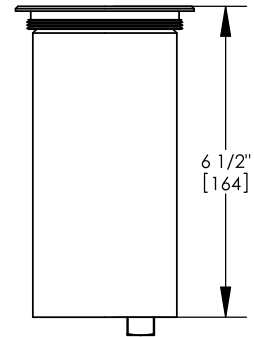
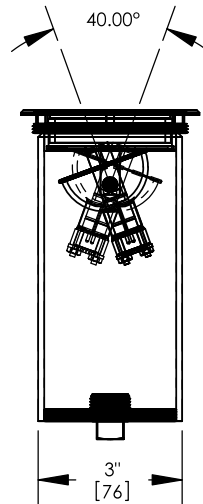
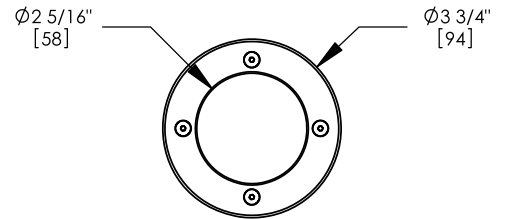
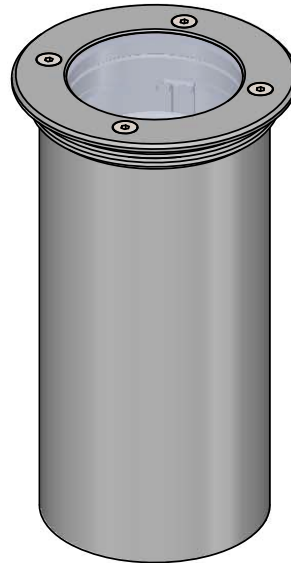

ORDER SPECIFICATION: _____ - _____ - _____ - _____ - _____
Fixture Finish Lamping Voltage Options/Access.

PROJECT:

APPROVED:

NOTE:

TYPE:

HEVI LITE, INC.

9714 Variel Ave, Chatsworth, CA 91311
 Tel., (818) 341-8091 - Fax (818) 998-1986
 Web Site <http://www.hevilite.com>

CATALOG NUMBER:

HL-822