

SPECIFICATIONS

DESCRIPTION:

Compact recessed in grade fixture with adjustable light source. Suitable for wet/damp location installations.

MATERIAL:

Standard overall material is brass
HL-834 - Cast Brass

FINISH:

- AP** - Powder Coat Aluminum
- BK** - Powder Coat Black
- BZ** - Powder Coat Bronze
- WT** - Powder Coat White
- N** - Natural Brass

□ / □ □ / 0 3, 1 □ □ 37, □ □ □
 / DPSZSHEDORH05ODPSELSL □ □ □
 EDVHEDRWLEFGHGWDGDUG □ □

/ 87, 116
 / WHUDOLRWSW/DUPLWH □ □ □
 / MWGDUGRWHUYDYDLODEOH □ □
 □ / / OPHM □ □ □
 □ / / OPHM □ □ □
 □ / / OPHM □ □ □

OPTICS

- 3LED and 8LED:
- SP** - Spot, 12°
 - NF** - Narrow Flood, 24°
 - FL** - Flood, 36°
- 8LED-E:
- SP** - Spot 14°
 - NF** - Narrow Flood, 25°
 - MF** - Medium Flood, 30°
 - FL** - Flood, 40°

VOLTAGE:

12 - 12 VAC output transformer required, not included. 2ft SJO cord included.

MOUNTING:

Suitable for installation into concrete, masonry or any other non-combustible material.

OPTIONS:

Pour Housing
HL-8PH - Brass flange, PVC tube
 See fixture accessories for more information.

SAMPLE ORDER SPECIFICATION:

HL-834-N-12-HL8PH

RATING:

Wet/damp location - IP67

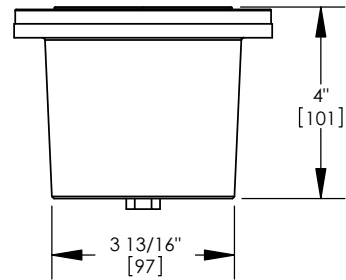
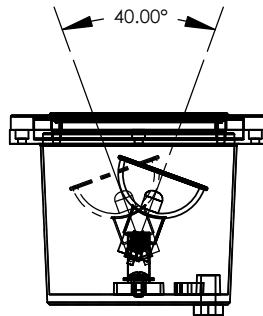
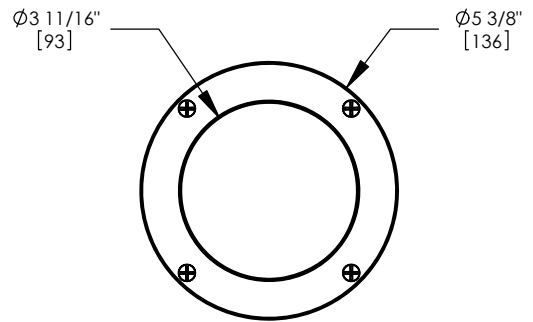
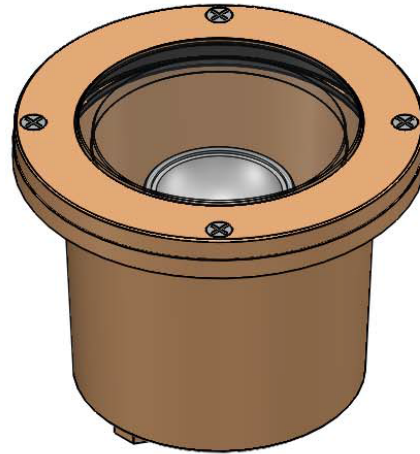

ORDER SPECIFICATION: _____ - _____ - _____ - _____ - _____
Fixture Finish Lamping Voltage Options/Access.

PROJECT: _____
 APPROVED: _____
 NOTE: _____
 TYPE: _____

HEVI LITE, INC.
 9714 Variel Ave, Chatsworth, CA 91311
 Tel., (818) 341-8091 - Fax (818) 998-1986
 Web Site <http://www.hevilite.com>

CATALOG NUMBER:
HL-834