

# SPECIFICATIONS

**DESCRIPTION:**

Machined dual square cover plate. Suitable for wet/damp/dry location installations.

**MATERIAL:**

Standard overall material is 6061 aluminum.  
**WM-3-2X** - Machined Aluminum (Standard)  
**WM-3-2X-2b** - Machined Brass

**FINISH:**

- AA** - Anodized Satin Aluminum
- AP** - Powder Coat Aluminum
- BK** - Powder Coat Black
- BZ** - Powder Coat Bronze
- WT** - Powder Coat White
- N** - Natural, for Stainless Steel and Brass

**MOUNTING:**

Cover is equipped with (2) 1/2-NPS mounts, locknut, gasket and (2) mounting screws.

**SAMPLE ORDER SPECIFICATION:**

WM-3-2b-N

**RATING:**

Wet/damp/dry location.

**MADE IN THE USA**

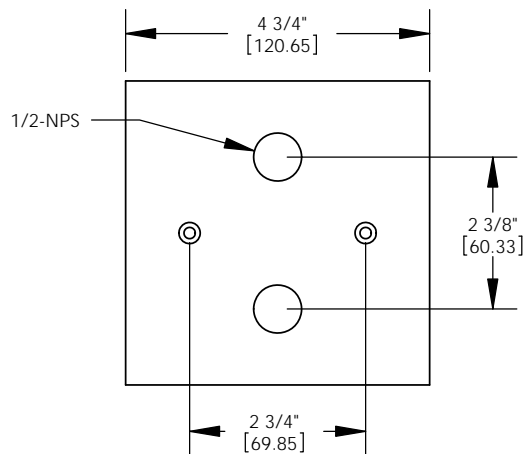
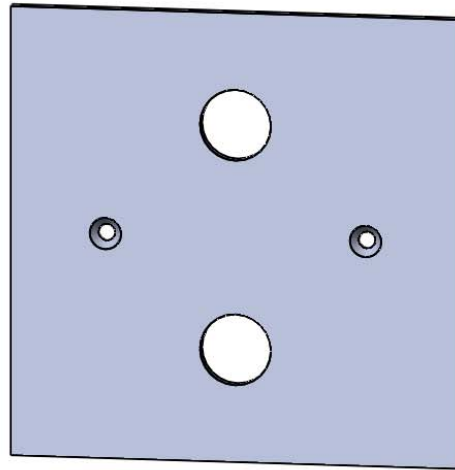

**ORDER SPECIFICATION:** \_\_\_\_\_ - \_\_\_\_\_ - \_\_\_\_\_ - \_\_\_\_\_ - \_\_\_\_\_  
Fixture Finish Lamping Voltage Options/Access.

**PROJECT:** \_\_\_\_\_  
**APPROVED:** \_\_\_\_\_  
**NOTE:** \_\_\_\_\_  
**TYPE:** \_\_\_\_\_

**H HEVI LITE, INC.**  
 9714 Variel Ave, Chatsworth, CA 91311  
 Tel., (818) 341-8091 - Fax (818) 998-1986  
 Web Site <http://www.hevilite.com>

CATALOG NUMBER:  
**WM-3-2X**