

# SPECIFICATIONS

**DESCRIPTION:**

LED flood light. Suitable for wet/damp/dry location installations.

**MATERIAL:**

Standard overall material is 6061 aluminum.  
**HL-905** - Machined Aluminum

**FINISH:**

- AA - Anodized Satin Aluminum
- AP - Powder Coat Aluminum
- BK - Powder Coat Black
- BZ - Powder Coat Bronze
- WT - Powder Coat White

**LED OPTIONS:**

Integral high output LED, warm white (3000K CCT) standard, others available.  
**3LED** - 3W LED  
**8LED** - 8W LED

**VOLTAGE:**

**12** - 12 VAC output transformer required, not included.

**MOUNTING:**

Fixture is designed with a 1/2-NPS adjustable mounting stem.

**ACCESSORIES:**

Glare shields  
**GL-93** - Angled, aluminum  
 See fixture accessories for more information.

**SAMPLE ORDER SPECIFICATION:**

HL-905

**RATING:**

Wet/damp/dry location.



**MADE IN THE USA**

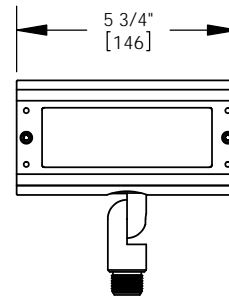
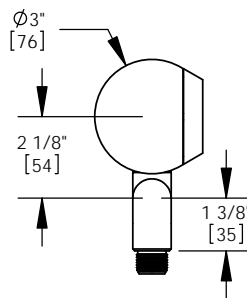

STANDARD

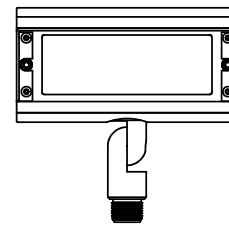
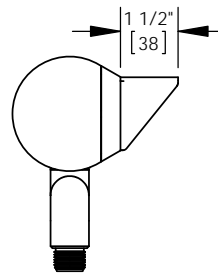

GLARE SHIELD

ORDER SPECIFICATION: \_\_\_\_\_ - \_\_\_\_\_ - \_\_\_\_\_ - \_\_\_\_\_ - \_\_\_\_\_  
Fixture Finish Lamping Voltage Options/Access.

PROJECT:

APPROVED:

NOTE:

TYPE:

**H HEVI LITE, INC.**  
 9714 Variel Ave, Chatsworth, CA 91311  
 Tel., (818) 341-8091 - Fax (818) 998-1986  
 Web Site <http://www.hevilite.com>

CATALOG NUMBER:

**HL-905**