

# SPECIFICATIONS

**DESCRIPTION:**

Compact rectangular shaped step light.  
Suitable for wet/damp/dry location installations.

**MATERIAL:**

Standard overall material is 6061 aluminum.

**FINISH:**

- AA - Anodized Satin Aluminum
- AP - Powder Coat Aluminum
- BK - Powder Coat Black
- BZ - Powder Coat Bronze
- WT - Powder Coat White

**HALOGEN LAMPING OPTION:**

Lamp Type - 12V halogen T3 lamp, bi-pin G4 base, 35W max, included (20W Xenon lamp included when halogen is not specified).

- 10 - 10W lamp
- 20 - 20W lamp
- 35 - 35W lamp

**LED OPTIONS:**

Integral high output LED, warm white (3000K CCT) standard, others available.

- 3LED - 3W LED
- 8LED - 8W LED

**VOLTAGE:**

12 - 12 VAC output transformer required, not included.

**MOUNTING:**

Mounts directly to standard single-gang electrical junction boxes.

**SAMPLE ORDER SPECIFICATION:**

HL-1182-AA-8LED-12

**RATING:**

Wet/damp/dry location.

**MADE IN THE USA**

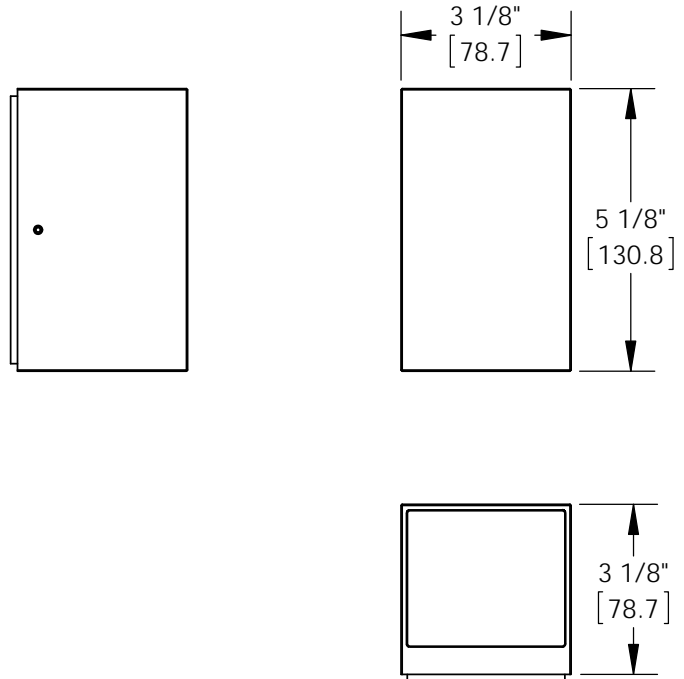
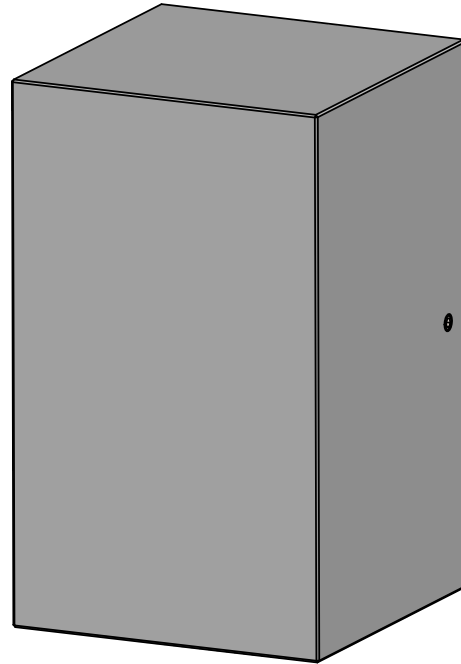

ORDER SPECIFICATION: _____	
Fixture	Finish
Lamping	Voltage
Options/Access.	
PROJECT:	<b>HEVI LITE, INC.</b> 9714 Variel Ave, Chatsworth, CA 91311 Tel., (818) 341-8091 - Fax (818) 998-1986 Web Site <a href="http://www.hevilite.com">http://www.hevilite.com</a>
APPROVED:	
NOTE:	
TYPE:	
CATALOG NUMBER:	
<b>HL-1182</b>	