

# SPECIFICATIONS

**DESCRIPTION:**  
Stainless steel low voltage 150W lighting magnetic transformer in 3R case. Suitable for wet location installations.

**VOLTAGE:**  
Transformer Type - Stepdown, low voltage, isolated secondary.  
Wattage - 150 VA  
Primary Voltage - 120 VAC - 1A max.  
Secondary Voltages - 12, 13, 14, 15  
Breakers - 1 x 15A  
Frequency - 60Hz.

**WEIGHT:**  
15LB

**MOUNTING:**  
Transformer case has 4 mounting holes. 6 foot primary line cord included.

**OPTIONS:**  
**TM** - Timer  
**PC** - Photocell

**RATING:**  
Meets or exceeds the UL standard 1838 for landscape lighting.

**MADE IN THE USA**

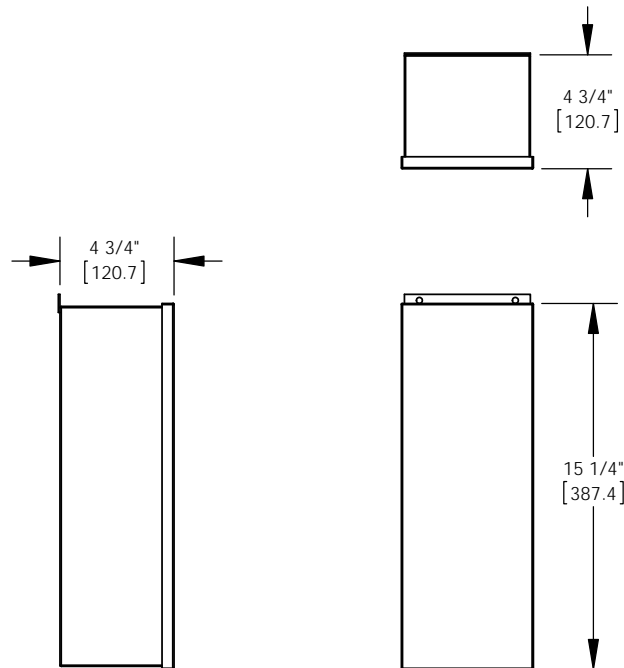
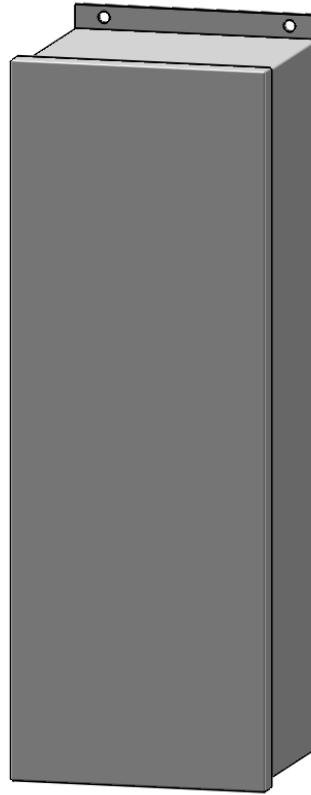

ORDER SPECIFICATION: \_\_\_\_\_ - \_\_\_\_\_ - \_\_\_\_\_  
Model Voltage Options/Access.

PROJECT:

APPROVED:

NOTE:

TYPE:

**H** HEVI LITE, INC.  
9714 Variel Ave, Chatsworth, CA 91311  
Tel., (818) 341-8091 - Fax (818) 998-1986  
Web Site <http://www.hevilite.com>

CATALOG NUMBER:

**HLT-SS-150-120**